



25 Clyde Square, London, E14 7TD

£250,000



25 Clyde Square, London, E14 7TD

£250,000

Barrain London Estate Agents is pleased to introduce to the market this very attractive apartment hidden away in a private corner of a quaint, cobbled courtyard in a pristine gated development. This very spacious gem of a property benefits from a concierge and tranquil, secure surroundings very close to the DLR.

\*\*\*\* Any buyer in Severn Court will inherit the rights of the advanced Right to Manage process and will become a Member of the RTM Company, securing their future interest in reduced and controlled costs. Participation in the development is approximately 70%

In Severn Court, modern convenience meets period charm. Just 8 minutes walk to Westferry station (DLR), and within easy walking distance of Jubilee and Elizabeth Line connections in bustling, glamorous Canary Wharf, you will always be just a short train ride from all the attractions of Greater London: the City in 20 minutes, Westfield Stratford in 20 minutes, City Airport in 25 minutes, Theatreland in 40 minutes, even Heathrow in just over 60 minutes!

This amazing flat is available now for private viewings, so please call us to arrange yours!

## Key Features

- Very spacious 1 bedroom modern apartment
- Conceive / long lease / CHAIN FREE
- Quiet, secure, gated development with charming period courtyard
- Minutes to Westferry DLR station and Canary Wharf / Elizabeth Line
- In the neighbourhood: LIDL, Narrow St period pubs, Limehouse Canal Walk, & Bartlett Park
- Great option for commuters, first time buyers, and buy-to-let investors!
- Buyer will inherit ongoing Right to Manage process to benefit from controlled costs

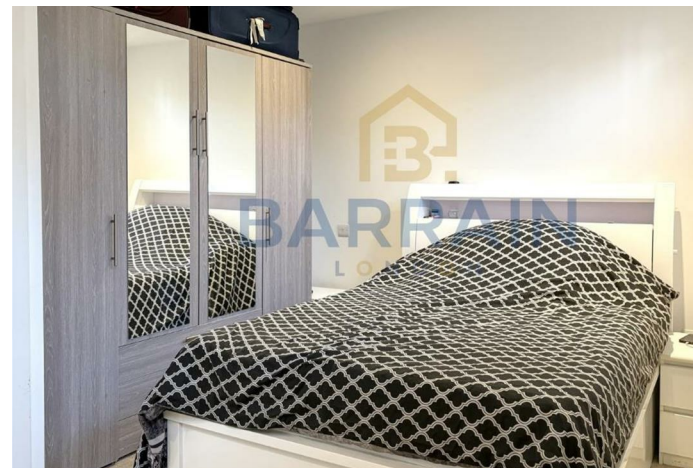

Council Tax Band: C

## Floor Plans

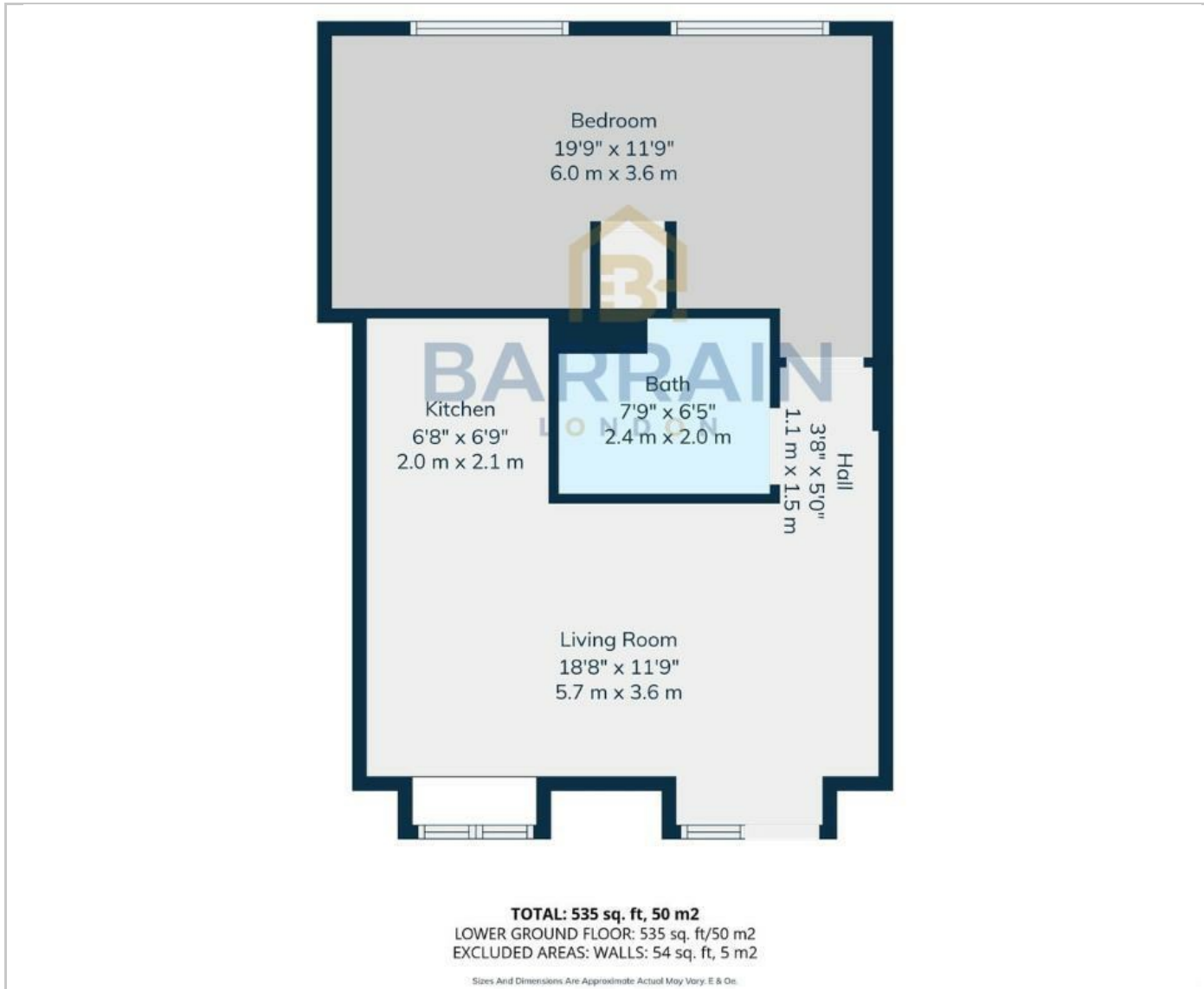

## Area Map

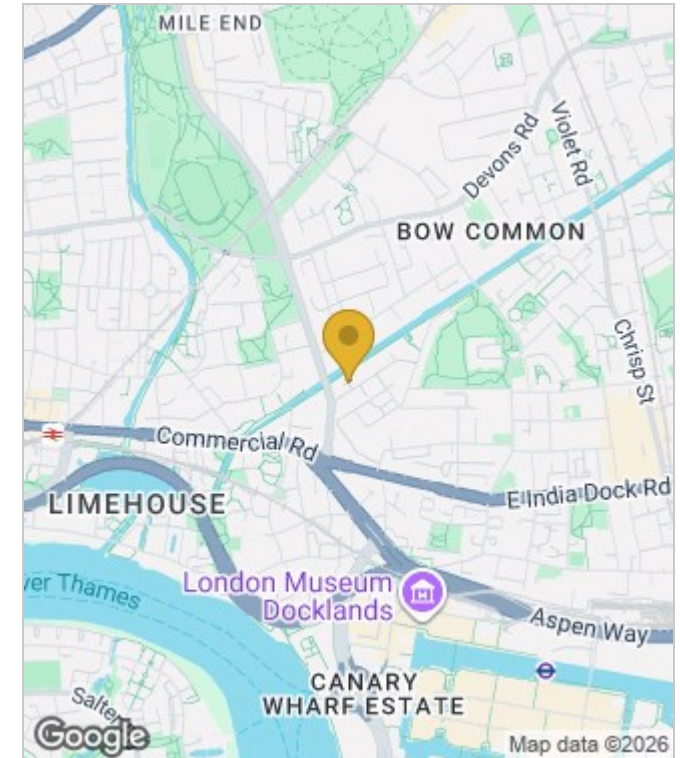

## Energy Performance Graph

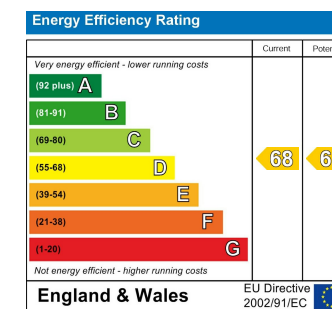

These particulars, whilst believed to be accurate are set out as a general outline only for guidance and do not constitute any part of an offer or contract. Intending purchasers should not rely on them as statements of representation of fact, but must satisfy themselves by inspection or otherwise as to their accuracy. No person in this firm's employment has the authority to make or give any representation or warranty in respect of the property.